

Site Accommodation

www.atcosl.com.au



Site Offices | Complexes | Lunchrooms | Toilets | Ablutions | Change Rooms | First Aid Rooms

ATCO Structures & Logistics



Contents

Business Profile	2
Offices	3
Lunchrooms	5
Change Rooms / First Aid	5
Toilets	6
Locations	7

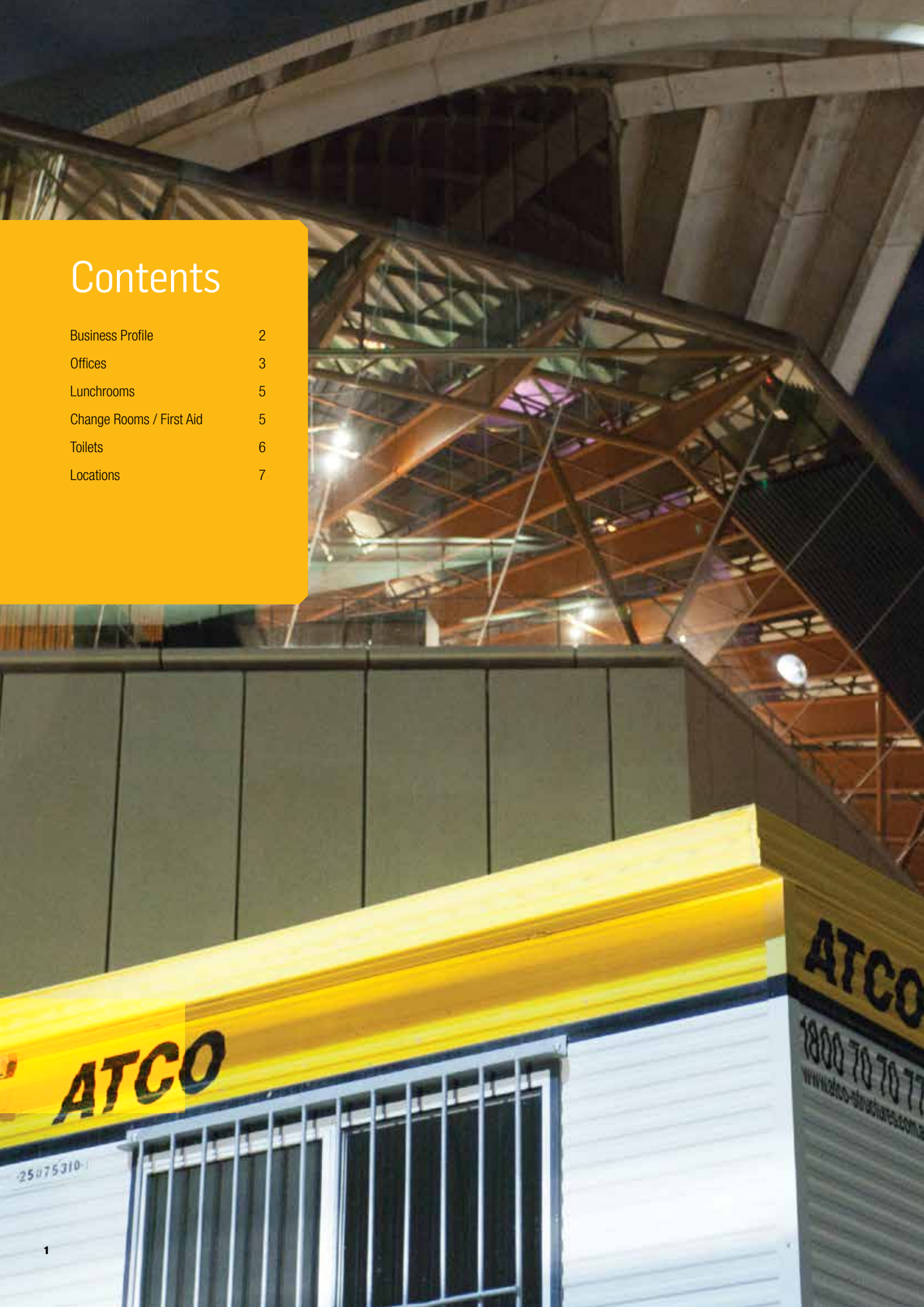

Business Profile

ATCO Structures & Logistics (ATCO) is recognised as one of Australia's leading modular building providers.

With a history that dates back to 1947, **ATCO** has a reputation of delivering modular solutions and associated site services on time and on budget. **ATCO** has been associated with numerous projects that have been milestones in shaping Australia's industrial history. **ATCO** has developed into an internationally recognised brand that has operations within North America, South America, Middle East, Asia and Europe.

ATCO has a primary focus within Australia and has developed a network of offices and infrastructure in Townsville, Mackay, Gladstone, Brisbane, Newcastle, Sydney, Melbourne and Perth to meet the ever changing construction and mining industry landscapes presented.

Having built one of Australia's largest rental fleets of modular buildings, **ATCO** are capable of mobilising project needs quickly. **ATCO**'s strength lies in their experience and ability to deliver when it counts. **ATCO** prides itself on providing Australian made products that are built to stand up to the demands of the rigorous environments encountered in remote Australia.

Defining our business through superior service, the company has retained and developed its workforce who are focused on delivering a multitude of project disciplines, whilst maintaining the core business ethics of professionalism and transparency.

ATCO has a diverse customer base and has expertise in delivering products to the construction, mining, education, oil and gas and commercial industries, with the ability to customise building design to suit a specific project requirement. The company has the expertise and capacity to deliver a rapid, full turnkey solution anywhere, anytime it is needed.

"Their adherence to safe processes and site requirements, combined with brilliant work ethics and pride in workmanship is a rare thing to find. I have no hesitation in recommending ATCO to anyone who requires this service."

Shell Refining (Australia) Pty Ltd



ALWAYS THERE. ANYWHERE.

Offices

3.0m x 3.0m Office
OF 100

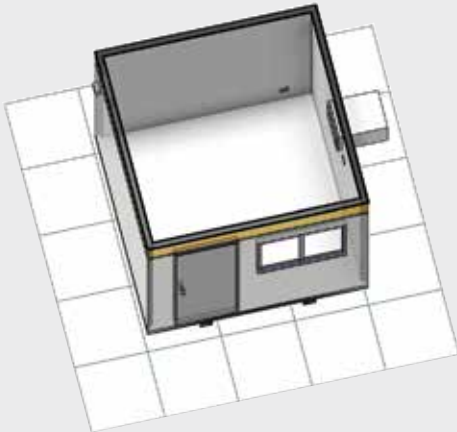

3.6m x 3.0m Office
OF 110

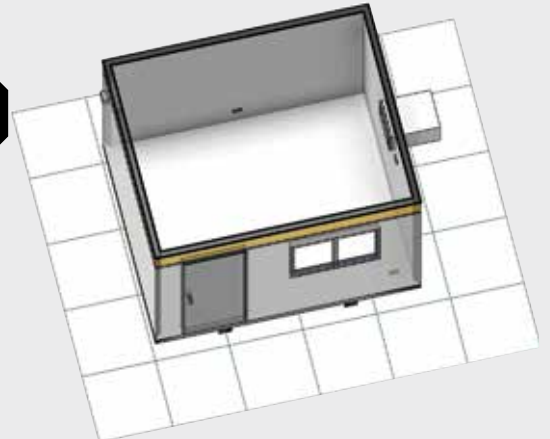

4.8m x 2.4m Office
OF 115

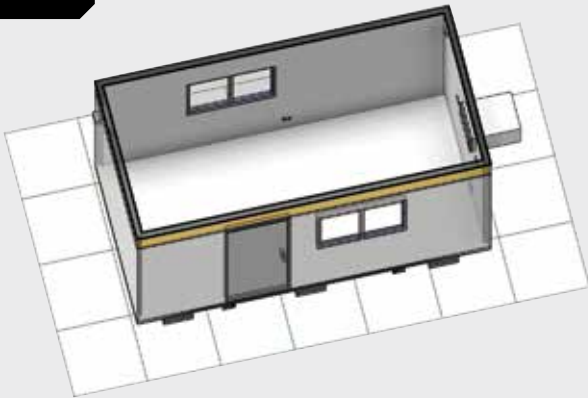

6.0m x 3.0m Office
OF 130

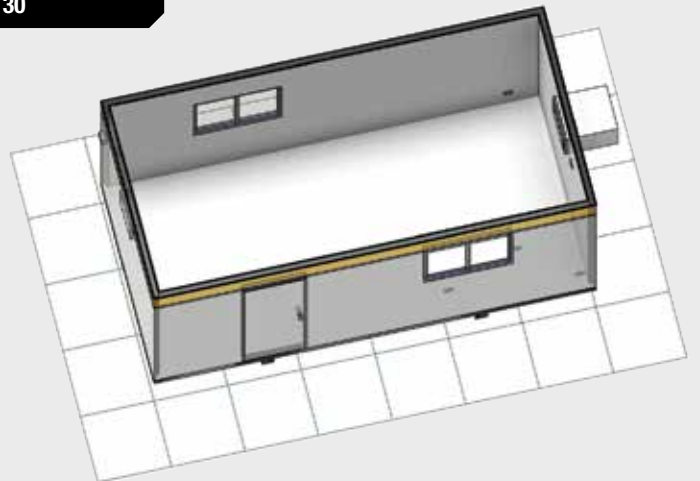

7.2m x 3.0m Office
OF 140

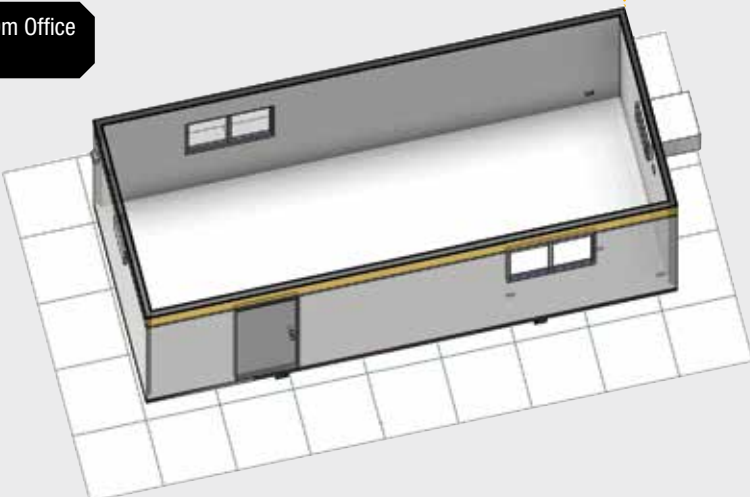

ALWAYS THERE. ANYWHERE.

12.0m x 3.0m Office
OF 190

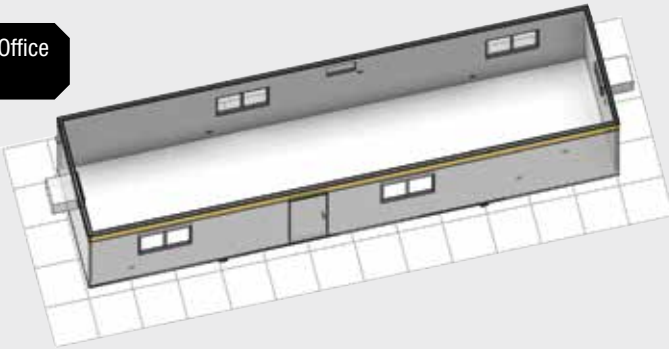

12.0m x 3.0m Office
OF 191



12.0m x 6.0m Office
OF 510

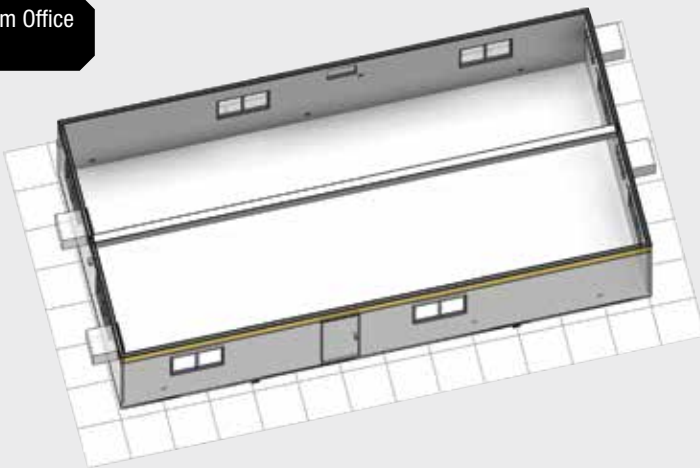

12.0m x 9.0m Office
OF 525



12.0m x 9.0m Office
OF 520

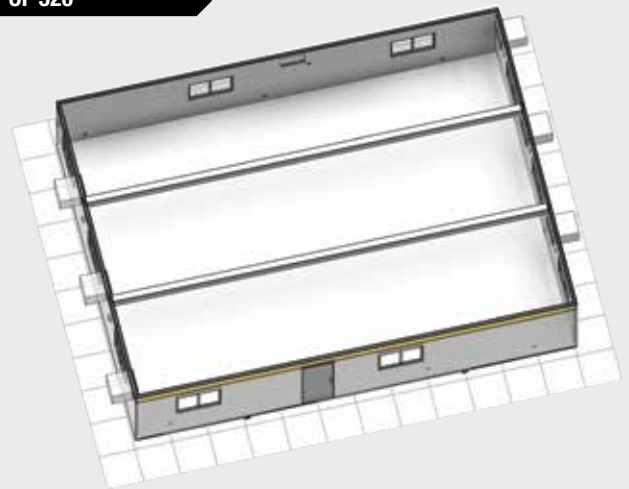

"I have been associated and dealing with ATCO Representatives from the start of 2003 up to the present day and within my relationship with ATCO staff we have achieved many projects such as installations of classrooms, sourcing office solutions and relocating buildings. These works have been carried out to an excellent standard and efficiently always finishing the tasks on time. I have no hesitation in recommending ATCO Structures Staff and the work they do to any prospective company wishing to contract them." Westside Christian College

Lunchrooms

Change Rooms / First Aid

4.8m x 2.4m Lunchroom
LR 010



4.8m x 3m Lunchroom
LR 012

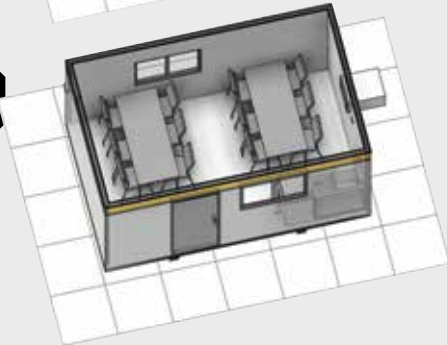

6.0m x 3.0m Lunchroom
LR 018

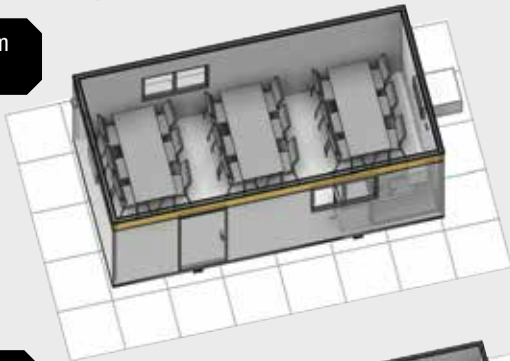

12.0m x 3.0m Lunchroom
LR 036



6.0m x 3.0m Change Room
CH 020

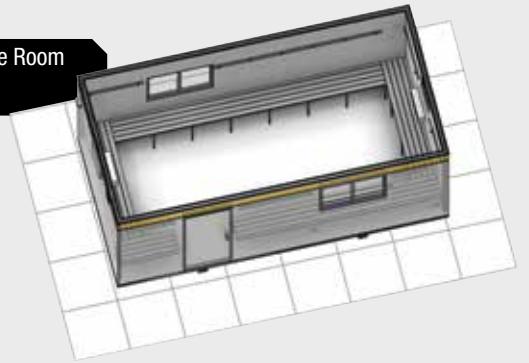

6.0m x 3.0m First Aid
FA 025

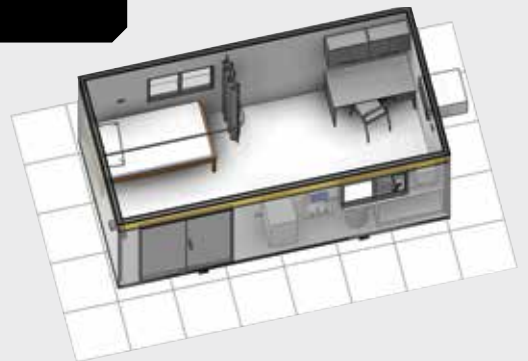

12.0m x 3.0m Change Room
CH 030



ALWAYS THERE. ANYWHERE.

Toilets

2.4m x 2.4m Male/
Female Toilet **MFT 010**



3.0m x 3.0m Toilet
WC 015

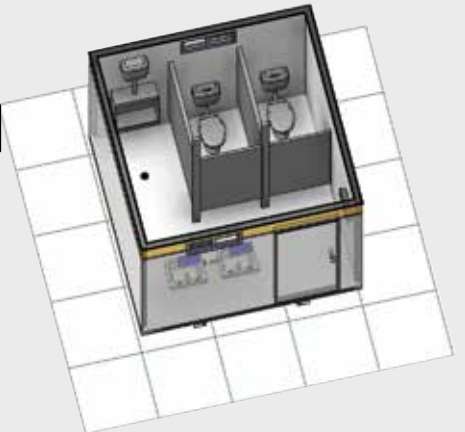

3.6m x 3.0m Toilet
WC 020

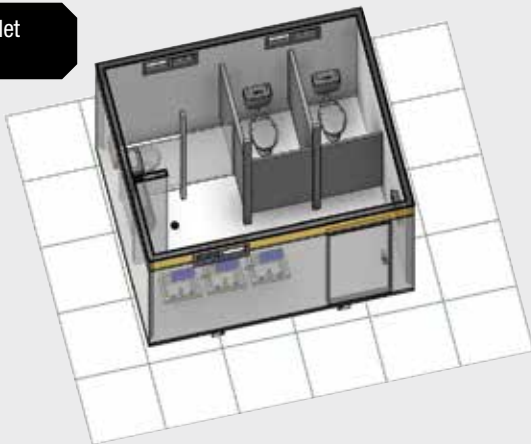

4.8m x 3.0m Male/
Female Toilet **MFT 015**

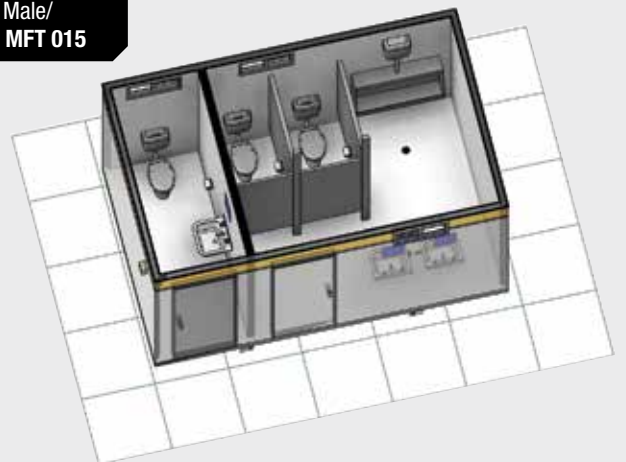

6.0m x 3.0m Ablution
AB 040

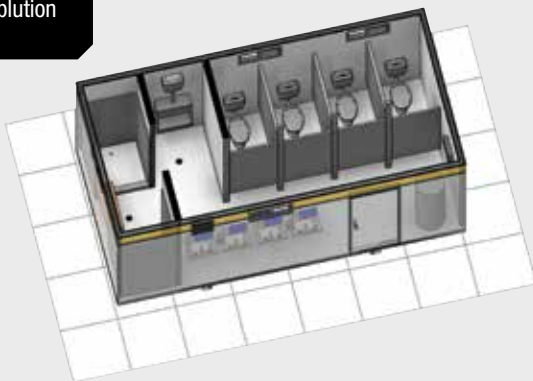

4.8m x 3.0m Ablution
AB 035

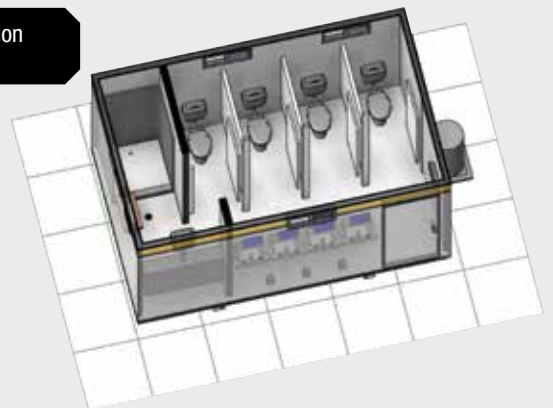

6.0m x 2.4m Tank

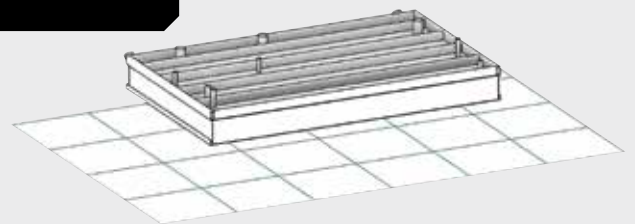

"ATCO were able to meet an extremely tight timeframe imposed by Melbourne Water for the delivery of the project offices and have positively responded to any requests by Melbourne Water to attend to site for minor issues. The site accommodation has been well received and the project was completed in a safe and efficient manner. I have no hesitation in recommending ATCO for any large or small project you may be considering them for." Melbourne Water

Locations

QUEENSLAND

Brisbane

(Australia Head Office)
ATCO Structures & Logistics Pty Ltd
149-151 Magnesium Drive
Crestmead QLD 4132
Phone: (61) 7 3412 8600
Fax: (61) 7 3803 6590

Brisbane

ATCO Structures & Logistics Pty Ltd
95 Quinns Hill Road East
Stapylton Qld 4207
Phone: (61) 7 3382 6299
Fax: (61) 7 3382 6288

Townsville

ATCO Structures & Logistics Pty Ltd
826 Ingham Road
Bohle QLD 4818
Phone: (61) 7 4795 6300
Fax: (61) 7 4774 6440

Mackay

ATCO Structures & Logistics Pty Ltd
Walker Complex, Harbour Road
Mackay QLD 4740
Phone: (61) 7 4829 3800
Fax: (61) 7 4942 4469

NEW SOUTH WALES

Newcastle

ATCO Structures & Logistics Pty Ltd
2376 Pacific Highway
Heatherbrae NSW 2324
Phone: (61) 2 4008 5600
Fax: (61) 2 4008 5699

Sydney

ATCO Structures & Logistics Pty Ltd
47 Mulgrave Road
Mulgrave NSW 2756
Phone: (61) 2 4545 2900
Fax: (61) 2 4577 7372

VICTORIA

Melbourne

ATCO Structures & Logistics Pty Ltd
128 Hallam Valley Rd
Dandenong South VIC 3175
Phone: (61) 3 8765 8200
Fax: (61) 3 9791 9271

WESTERN AUSTRALIA

Perth

ATCO Structures & Logistics Pty Ltd
28 Armstrong Road
Hope Valley WA 6165
Phone: (61) 8 6252 6200
Fax: (61) 8 6252 6299



ATCO Structures & Logistics

For further information

Telephone – (61) 7 3412 8600

Facsimile – (61) 7 3803 6590

www.atcosl.com.au

